

This drawing is the property of Bradley Murphy Design Ltd. Copyright is reserved by them and the drawing is issued on the condition that it is not copied, reproduced, retained nor disclosed to any unauthorized person either wholly or in part without the consent of Bradley Murphy Design Ltd.

OS Crown Copyright 2020 Licence Number 100022432

- APPLICATION BOUNDARY
- EXTENT OF LEASEHOLD LAND
- DISTANCE FROM CENTRE OF THE SITE
- PROPOSED SUBSTATIONS (3.2M) AND TALLER
- PROPOSED PODIUM GARDENS (3.2M) AND TALLER
- PROPOSED BLOCK 11 (16.5M PARAPET HEIGHT + ROOF STRUCTURES) AND TALLER
- PROPOSED BLOCK 12 (16.5M PARAPET HEIGHT + ROOF STRUCTURES) AND TALLER
- PROPOSED BLOCK 9 (16.7M PARAPET HEIGHT + ROOF STRUCTURES) AND TALLER
- PROPOSED BLOCK 10 (23.6M PARAPET HEIGHT + ROOF STRUCTURES) AND TALLER
- PROPOSED BLOCK 4 (25.6M PARAPET HEIGHT + ROOF STRUCTURES) AND TALLER
- PROPOSED BLOCK 6 (26.1M PARAPET HEIGHT + ROOF STRUCTURES) AND TALLER
- PROPOSED BLOCK 7 (26.1M PARAPET HEIGHT + ROOF STRUCTURES) AND TALLER
- PROPOSED BLOCK 8 (26.1M PARAPET HEIGHT + ROOF STRUCTURES) AND TALLER
- PROPOSED BLOCK 1 (27.2M PARAPET HEIGHT + ROOF STRUCTURES) AND TALLER
- PROPOSED BLOCK 2 & 3 (28.7M PARAPET HEIGHT + ROOF STRUCTURES) AND TALLER
- PROPOSED BLOCK 5 (35.6M PARAPET HEIGHT + ROOF STRUCTURES) AND TALLER
- SETTLEMENTS (ASSUMED HEIGHT: 9m ABOVE LANDFORM)
- ESTABLISHED WOODLAND BLOCKS & BELTS (ASSUMED HEIGHT: 12m ABOVE LANDFORM)

C	UPDATED PARAMETERS	29.07.20
B	MINOR AMENDMENTS	14.07.20
A	UPDATED TO JULY 2020 PARAMETERS	13.07.20
Rev	Description	Date

Purpose of Issue
PLANNING

Bradley Murphy Design Ltd
6 The Courtyard
Hatton Technology Park
Dark Lane
Hatton
Warwickshire
CV35 8XB

t: 01926 676496
e: info@bradleymurphydesign.co.uk
www.bradleymurphydesign.co.uk

Client



InLand Homes			
Project HILLINGDON GARDENS			
Drawing Title Figure 3: ZTV - 2020 Parameters Bare Earth			
Drawn RR	Checked YY	Approved RW	Date 05/09/2019
Job No. 19.020	Scale As Shown	Sheet Size A3	Revision C
Drawing Number BMD.19.020.TVIA.FIG.003			

Figure 3 : Zone of Theoretical Visibility Bare Earth, represents the worst case scenario. This treats landform as if it were 'bare earth' and illustrates the area within which the development would theoretically be visible assuming other vertical features within the landscape and built environment (such as buildings, infrastructure and vegetation) would not act as barriers to views toward the development.

Note: The ZTV models the height parameters for roof terrace, parapet and roof structures, including plant and stairwell, for each development block.

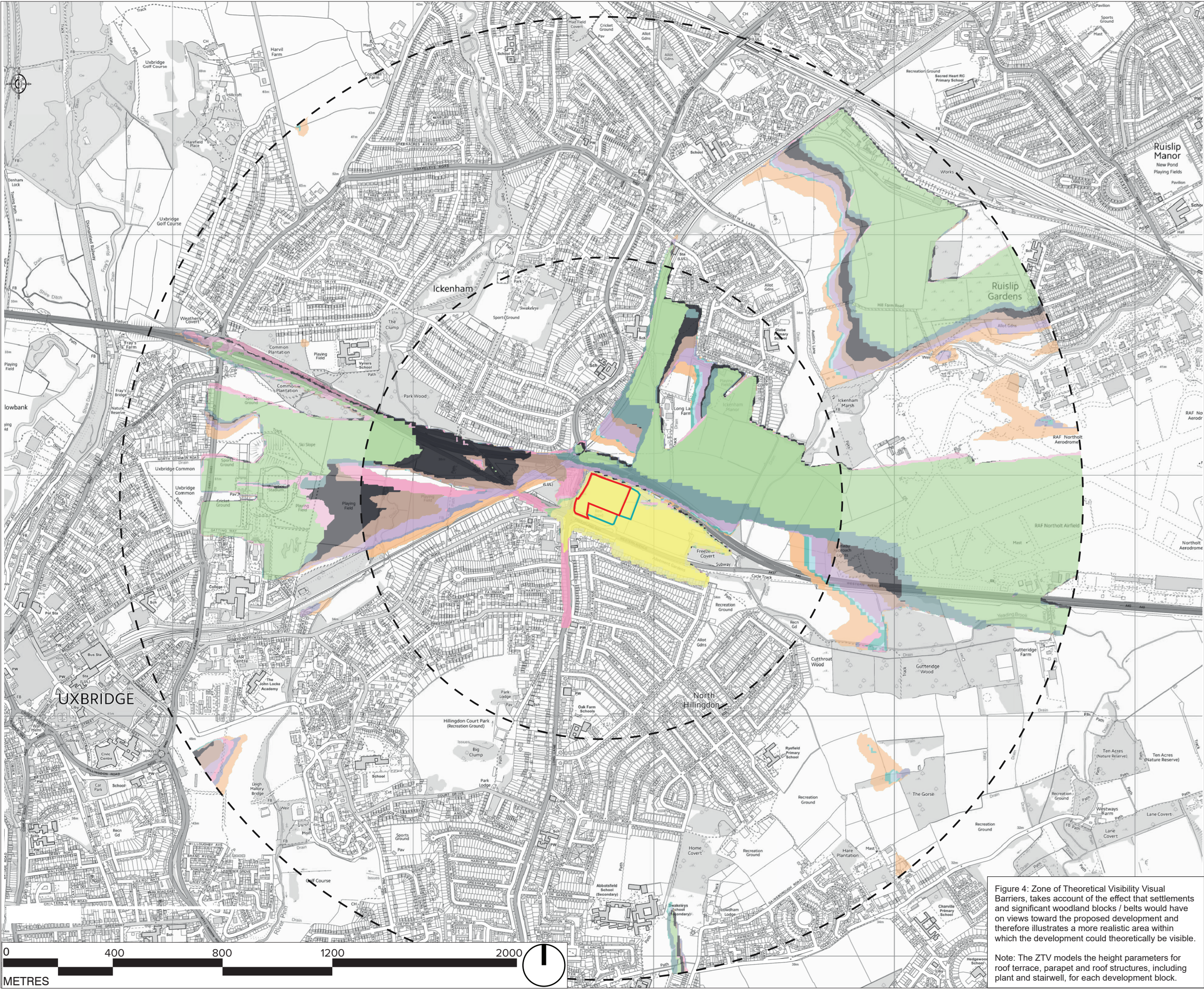

This drawing is the property of Bradley Murphy Design Ltd. Copyright is reserved by them and the drawing is issued on the condition that it is not copied, reproduced, retained nor disclosed to any unauthorized person either wholly or in part without the consent of Bradley Murphy Design Ltd.

OS Crown Copyright 2020 Licence Number 100022432

- APPLICATION BOUNDARY
- EXTENT OF LEASEHOLD LAND
- DISTANCE FROM CENTRE OF THE SITE
- PROPOSED SUBSTATIONS (3.2M) AND TALLER
- PROPOSED PODIUM GARDENS (3.2M) AND TALLER
- PROPOSED BLOCK 11 (16.5M PARAPET HEIGHT + ROOF STRUCTURES) AND TALLER
- PROPOSED BLOCK 12 (16.5M PARAPET HEIGHT + ROOF STRUCTURES) AND TALLER
- PROPOSED BLOCK 9 (16.7M PARAPET HEIGHT + ROOF STRUCTURES) AND TALLER
- PROPOSED BLOCK 10 (23.6M PARAPET HEIGHT + ROOF STRUCTURES) AND TALLER
- PROPOSED BLOCK 4 (25.6M PARAPET HEIGHT + ROOF STRUCTURES) AND TALLER
- PROPOSED BLOCK 6 (26.1M PARAPET HEIGHT + ROOF STRUCTURES) AND TALLER
- PROPOSED BLOCK 7 (26.1M PARAPET HEIGHT + ROOF STRUCTURES) AND TALLER
- PROPOSED BLOCK 8 (26.1M PARAPET HEIGHT + ROOF STRUCTURES) AND TALLER
- PROPOSED BLOCK 1 (27.2M PARAPET HEIGHT + ROOF STRUCTURES) AND TALLER
- PROPOSED BLOCK 2 & 3 (28.7M PARAPET HEIGHT + ROOF STRUCTURES) AND TALLER
- PROPOSED BLOCK 5 (35.6M PARAPET HEIGHT + ROOF STRUCTURES) AND TALLER
- SETTLEMENTS (ASSUMED HEIGHT: 9m ABOVE LANDFORM)
- ESTABLISHED WOODLAND BLOCKS & BELTS (ASSUMED HEIGHT: 12m ABOVE LANDFORM)

C	UPDATED PARAMETERS	29.07.20
B	MINOR AMENDMENTS	14.07.20
A	UPDATED TO JULY 2020 PARAMETERS	13.07.20
Rev	Description	Date

Purpose of Issue
PLANNING

Bradley Murphy Design Ltd
6 The Courtyard
Hatton Technology Park
Dark Lane
Hatton
Warwickshire
CV35 8XB

t: 01926 676496
e: info@bradleymurphydesign.co.uk
www.bradleymurphydesign.co.uk

Client



InLand Homes

Project
HILLINGDON GARDENS

Drawing Title
Figure 4: ZTV - 2020 Parameters Visual Barriers

Drawn RR	Checked YY	Approved RW	Date 05/09/2019
Job No. 19.020	Scale As Shown	Sheet Size A3	Revision C
Drawing Number BMD.19.020.TVIA.FIG.004			

Figure 4: Zone of Theoretical Visibility Visual Barriers, takes account of the effect that settlements and significant woodland blocks / belts would have on views toward the proposed development and therefore illustrates a more realistic area within which the development could theoretically be visible.

Note: The ZTV models the height parameters for roof terrace, parapet and roof structures, including plant and stairwell, for each development block.